

# Supreme Duty Hose Reels

AVAILABLE IN: **SPRING DRIVEN**

**EZ-COIL™**

## T SERIES

**Coxreels' T Series "Truck Mount" spring driven hose reels are the toughest hose reels in the spring driven line.** The extra large chassis is strongly supported by dual pedestal-style arms that span from the roller guide bracket down to the sturdy mounting base. Triple support points to the center shaft are complemented by Coxreels' original Super Hub support system. They're perfect for off-road applications that demand reliability in the most abusive and demanding environments.

**LOW PRESSURE** Models with hose are for air or water service with a maximum temperature 150° F. Models less hose can be used for air, water or oil. **NOTE: Do not exceed listed hose O.D. to obtain maximum length.**

HOSE						LESS HOSE		SIZE INDEX
MODEL	I.D.	O.D.	FT.	PSI	APRX. LBS.	MODEL	APRX. LBS.	
TSH-N-350	3/8"	21/32"	50	300	61	TSHL-N-350	55	1
TSH-N-375	3/8"	21/32"	75	300	82	TSHL-N-375	73	3
TSH-N-3100	3/8"	21/32"	100	300	85	TSHL-N-3100	74	3
TSH-N-3125	3/8"	21/32"	125	300	103	TSHL-N-3125	90	3
TSH-N-450	1/2"	27/32"	50	300	63	TSHL-N-450	55	2
TSH-N-475	1/2"	27/32"	75	300	82	TSHL-N-475	71	3
TSH-N-4100	1/2"	27/32"	100	300	95	TSHL-N-4100	80	3
TSH-N-535	3/4"	15/32"	35	300	77	TSHL-N-535	67	5
TSH-N-550	3/4"	15/32"	50	300	83	TSHL-N-550	70	5
TSHF-N-550*	3/4"	15/32"	50	300	91	TSHL-N-550	70	5
TSH-N-635	1"	17/16"	35	300	92	TSHL-N-635	71	6
TSHF-N-635*	1"	17/16"	35	300	95	TSHL-N-635	71	6

\*These models are supplied with fuel hose

**MEDIUM PRESSURE** Reels are furnished with standard one wire braid hose suitable for air, water or oil applications. Maximum temperature 250° F. **NOTE: Do not exceed listed hose O.D. to obtain maximum length.**

HOSE						LESS HOSE		SIZE INDEX
MODEL	I.D.	O.D.	FT.	PSI	APRX. LBS.	MODEL	APRX. LBS.	
TMP-N-350	3/8"	5/8"	50	3000	74	TMPL-N-350	61	2
TDMP-N-350**	3/8"	5/8"	50	3000	104	TDMP-N-350	79	7
TMP-N-375	3/8"	5/8"	75	3000	99	TMPL-N-375	80	3
TMP-N-3100	3/8"	21/32"	100	3000	106	TMPL-N-3100	82	3
TMP-N-450	1/2"	3/4"	50	2500	77	TMPL-N-450	64	2
TDMP-N-450**	1/2"	3/4"	50	2500	106	TDMP-N-450	78	7
TMP-N-475	1/2"	3/4"	75	2500	100	TMPL-N-475	80	3
TMP-N-4100	1/2"	3/4"	100	2500	106	TMPL-N-4100	80	3
TMP-N-525	3/4"	1"	25	1500	67	TMPL-N-525	57	4
TMP-N-535	3/4"	1"	35	1500	88	TMPL-N-535	74	5
TMP-N-550	3/4"	1"	50	1500	94	TMPL-N-550	74	5

\*\*These models are designed for dual-hydraulic hose applications. See page 22

**HIGH PRESSURE** Reels are furnished standard with S.A.E. 100R16 #1 or #2 wire braid hose suitable for grease and hydraulic oil applications. Maximum temp. 250° F. **NOTE: Do not exceed listed hose O.D. to obtain maximum length.**

HOSE						LESS HOSE		SIZE INDEX
MODEL	I.D.	O.D.	FT.	PSI	APRX. LBS.	MODEL	APRX. LBS.	
THP-N-150	1/4"	17/32"	50	5000	74	THPL-N-150	62	2
THP-N-175	1/4"	17/32"	75	5000	88	THPL-N-175	71	3
THP-N-1100	1/4"	17/32"	100	5000	104	THPL-N-1100	82	3
THP-N-350	3/8"	43/64"	50	4000	78	THPL-N-350	66	4
THP-N-375	3/8"	43/64"	75	4000	98	THPL-N-375	80	5

**REEL DIMENSIONS** Technical Data Sheets Available On Website

SIZE INDEX	A	B	C	D	E	MOUNT L-M
1	8 3/4"	21 3/16"	19 5/8"	8"	9"	7" - 8"
2	9 1/4"	21 3/16"	19 5/8"	8"	9"	7" - 8"
3	9 1/4"	25 1/2"	23"	8"	9"	7" - 8"
4	9 3/4"	21 3/16"	19 5/8"	8"	9"	7" - 8"
5	9 3/4"	25 1/2"	23"	8"	9"	7" - 8"
6	10"	25 1/2"	23"	8"	9"	7" - 8"
7	10 3/4"	25 1/2"	23"	8"	9"	7" - 8"

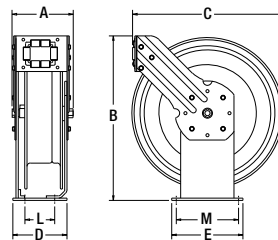

**TRIPLE AXLE SUPPORT WITH "SUPER HUB"**



"Super Hub"

### T SERIES OFFERS...

- Hose I.D.:** 1/4" - 1" **Pressure:** To 5,000 PSI
- ✓ Dual Pedestal-Style Support Arms & Base
  - ✓ Triple Axle Support Points to the Center Shaft With Coxreels' Original "Super Hub" Axle Support System
  - ✓ Built for Rugged Mobile Applications
  - ✓ Swivel Seals: NITRILE

- SPRING DRIVEN FEATURES:**
- ✓ Auto Rewind Easily Wraps, Stores & Protects Hose
  - ✓ Heavy Gauge Steel Base & Support Post
  - ✓ Factory-Matched Cartridge-Style Spring Motor
  - ✓ Solid Machined Brass Swivel (Zinc Plated Steel On HP Models)
  - ✓ 1" Solid Steel Axle With 1" Lubricated Precision Bearings
  - ✓ Guide Arm Adjusts To Wall, Floor & Overhead Positions
  - ✓ Multi-Position Lock Ratchet Secures Hose At Desired Length
  - ✓ Non-Corrosive Stainless Steel Spring, Pawl & Zinc Plated Ratchet

- PLUS... COXREELS' SIGNATURE FEATURES**
- Professional Grade Heavy Duty Steel Construction
  - Durable Proprietary "CPC" Powder Coat Process
  - Rolled Edges & Ribbed Discs Provide Strength & Safety
  - Leading 2-Year Manufacturer's Limited Warranty
  - Made In The U.S.A. Sold & Supported Worldwide

**HOW TO ORDER?**  
See Page 5 For Details

**UPGRADE TO COXREELS' EZ-COIL™**  
Powder Safety System  
See Page 3 For Details

MODELS AVAILABLE WITH **STAINLESS STEEL**  
FLUID PATH & CONSTRUCTION  
See Page 15 For Details

**PREMIUM HOSE UPGRADE**  
See Page 30 For Details

See Page 30 For Hose Assemblies & Component Parts

### AVAILABLE OPTIONS

**MOUNTING BRACKET: #MRT-1** - For overhead mounting, fits 3" to 8 1/2" flange on "I" or "H" beam. Powder coated crinkle black 3/16" bent steel. Weight: 13 lbs.

**SWING BRACKET: #15725** - For vertical surface mounting, allows reel to swing 180°. Powder coated crinkle black 3/16" steel. Weight: 5 lbs.

**SWIVEL BRACKET: #15721** - For horizontal surface mounting, ball bearing rotation, allows reel to swivel 345°. Powder coated crinkle black heavy gauge steel. Weight: 6 lbs.



Toll Free 800-COX-REEL • Fax 800-229-REEL • Int 480-820-6396 • Fax 480-820-5132 • [www.coxreels.com](http://www.coxreels.com)



CATALOG #CMC05 ©Copyright 2005 COXREELS