

High Capacity Hose Reels

AVAILABLE IN: **SPRING DRIVEN**

SP SERIES

Coxreels' SP Series "Single Product Delivery" spring driven hose reels are built to handle large hose diameters. Used in applications demanding large volume delivery in low and medium pressures such as fuel and water. The sturdy box-style frame has heavy duty steel cross supports to all four corners for extra strength and rigidity.

LOW PRESSURE Two braid hose for applications 250 to 300 psi and temperatures to 150° fahrenheit. Reel less hose 250° fahrenheit. For higher temperatures and pressures, see price sheet or consult factory. **NOTE: Do not exceed listed hose O.D. to obtain maximum length.**

HOSE						LESS HOSE		SIZE INDEX	
MODEL	I.D.	O.D.	FT.	PSI	INLET/OUTLET N.P.T.	APRX. LBS.	MODEL		APRX. LBS.
SLP-4100	1/2"	7/8"	100	300	1/2"	111	SLPL-4100	96	1
SLP-550	3/4"	1 1/4"	50	300	3/4"	99	SLPL-550	86	2
SLPF-550*	3/4"	1 1/4"	50	300	3/4"	107	SLPL-550	86	2
SLP-575	3/4"	1 1/4"	75	300	3/4"	136	SLPL-575	117	3
SLP-5100	3/4"	1 1/4"	100	300	3/4"	151	SLPL-5100	126	4
SLP-625	1"	1 7/16"	25	300	1"	106	SLPL-625	90	5
SLP-650	1"	1 7/16"	50	300	1"	139	SLPL-650	109	6
SLPF-650*	1"	1 7/16"	50	300	1"	142	SLPL-650	109	6
SLP-675	1"	1 7/16"	75	300	1"	193	SLPL-675	148	7
Please Consult Factory For Reels With Hose	1 1/4"	1 13/16"	25	250	1 1/2"	-	SLPL-725	110	8
	1 1/4"	1 13/16"	50	250	1 1/2"	-	SLPL-750	123	9
	1 1/2"	2 1/16"	25	250	1 1/2"	-	SLPL-825	107	8
	1 1/2"	2 1/16"	35	250	1 1/2"	-	SLPL-835	128	9
	1 1/2"	2 1/16"	50	250	1 1/2"	-	SLPL-850	138	10

*These models are supplied with fuel hose

MEDIUM PRESSURE 100 RI hose for applications 1500 to 2500 psi and temperatures to 250° fahrenheit. For higher temperatures and pressures, see price sheet or consult factory. **NOTE: Do not exceed listed hose O.D. to obtain maximum length.**

HOSE						LESS HOSE		SIZE INDEX	
MODEL	I.D.	O.D.	FT.	PSI	INLET/OUTLET N.P.T.	APRX. LBS.	MODEL		APRX. LBS.
SMP-4100	1/2"	29/32"	100	2500	1/2"	139	SMPL-4100	113	1
SMP-550	3/4"	1 3/16"	50	1500	3/4"	109	SMPL-550	89	5
SMP-575	3/4"	1 3/16"	75	1500	3/4"	151	SMPL-575	121	6
SMP-5100	3/4"	1 3/16"	100	1500	3/4"	165	SMPL-5100	126	6
Please Consult Factory For Reels With Hose	1"	1 1/2"	25	2000	1"	-	SMPL-625	92	5
	1"	1 1/2"	50	2000	1"	-	SMPL-650	110	6
	1"	1 1/2"	75	2000	1"	-	SMPL-675	135	9

REEL DIMENSIONS

Technical Data Sheets Available On Website

SIZE INDEX	A	B	C	D	E	F	G
1	10 1/2"	7 1/2"	20"	15 3/8"	19 1/2"	22 1/2"	20 1/2"
2	10 1/2"	7 1/2"	20"	15 3/8"	19"	22 1/2"	20 1/2"
3	10 1/2"	7 1/2"	24"	15 3/8"	19"	26"	24 1/2"
4	10 1/2"	7 1/2"	24"	15 3/8"	20"	26"	24 1/2"
5	10 1/2"	7 1/2"	20"	15 3/8"	20 1/2"	22 1/2"	20 1/2"
6	10 1/2"	7 1/2"	24"	15 3/8"	21"	26"	24 1/2"
7	10 1/2"	7 1/2"	28"	15 3/8"	21"	30"	28 1/2"
8	10 1/2"	7 1/2"	24"	15 3/8"	18"	26"	24 1/2"
9	10 1/2"	7 1/2"	28"	15 3/8"	18"	30"	28 1/2"
10	10 1/2"	9 1/2"	28"	17 3/8"	20"	30"	28 1/2"

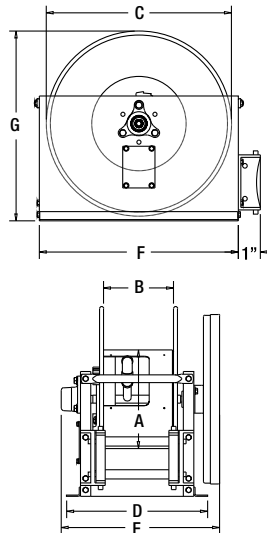

AVAILABLE OPTIONS

See Page 5 For Mounting Positions

FOUR ROLLER ASSEMBLY: #8100 (For 3/8" - 3/4") or **#8101** (For 1" - 1 1/2") - 4-way enclosed pinch-proof stainless steel rollers are 1" in diameter supported by powder coated steel brackets. Specify drum width. Weight: 8 lbs.



TOP REWIND ASSEMBLY: #8100 (For 3/8" - 3/4") or **#8101** (For 1" - 1 1/2") & **20458** - 4-way enclosed pinch-proof stainless steel rollers are 1" in diameter supported by powder coated steel brackets. Specify ceiling mount & specify drum width. Weight: 10 lbs.



TOP REWIND ASSEMBLY (WALL OR FLOOR MOUNT): #8100 (For 3/8" - 3/4") or **#8101** (For 1" - 1 1/2") & **20458** - 4-way enclosed pinch-proof stainless steel rollers are 1" in diameter supported by powder coated steel brackets. Specify wall or floor mount & specify drum width. Weight: 10 lbs.



SLPF With Fuel Hose

SP SERIES OFFERS...

- Hose I.D.:** 1/2" - 1 1/2" **Pressure:** To 2,500 PSI
- ✓ Auto Rewind Easily Wraps, Stores & Protects Hose
 - ✓ Reinforced Steel Frame Provides Maximum Strength & Stability
 - ✓ Lubricated Factory-Matched Cartridge-Style Spring Motor
 - ✓ Long Lasting Self-Lubricated Flange Bearings
 - ✓ Cast Iron Lock Ring With Non-Sparking Bronze Pawl
 - ✓ Non-Corrosive Stainless Steel Spring
 - ✓ Heavy Duty 1" O.D. Stainless Steel Pinch-Proof Rollers
 - ✓ Adjusts To Wall, Floor & Overhead Positions
 - ✓ Swivel Seals: NITRILE (AFLAS, On 1" Models)

SPRING DRIVEN FEATURES:

- ✓ Low Profile Outlet Riser & Open Drum Slot Design
- ✓ Full-Flow Swivel Assures Maximum Product Delivery
- ✓ Multi-Position Lock Ratchet Secures Hose At Desired Length
- ✓ All Working Parts Are Easily Accessible For Servicing

PLUS... COXREELS' SIGNATURE FEATURES

- Professional Grade Heavy Duty Steel Construction
- Durable Proprietary "CPC" Powder Coat Process
- Rolled Edges & Ribbed Discs Provide Strength & Safety
- Leading 2-Year Manufacturer's Limited Warranty
- Made In The U.S.A. Sold & Supported Worldwide

HOW TO ORDER? **PREMIUM HOSE UPGRADE**
See Page 5 For Details See Page 30 For Details

See Page 30 For Hose Assemblies & Component Parts



Toll Free 800-COX-REEL • Fax 800-229-REEL • Int 480-820-6396 • Fax 480-820-5132 • www.coxreels.com

